

# MER

## Metallized Polyester MOTOR RUN/AC Film Capacitors in Round Tubes

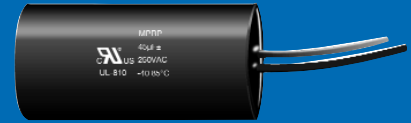

### APPLICATIONS

- *Motor Run*
- *General Purpose AC*
- *UL/CSA 810 approved*
- *Motor Speed Controls*
- *Switching capacitor for industrial controls*

### SPECIFICATIONS

<b>Operating Temperature Range</b>		<b>-25°C to +85°C</b>							
<b>Capacitance Tolerance</b>		<b>±10% at 1kHz, 20°C ±5%, +10%/-5% optional</b>							
<b>AC Voltage</b>	<b>VAC</b>	<b>250</b>	<b>350</b>	<b>400</b>	<b>450</b>	<b>500</b>	<b>600</b>		
		Note VAC must be de-rated by 1.25% per °C exceeding 70°C							
<b>Dissipation Factor (tan δ)</b>		<b>1.0% Max at 1 kHz and 20°C</b>							
<b>Insulation Resistance @20°C (&lt;70% RH) for 1 minute at 100VDC applied</b>		<b>1000MΩxμF</b>							
<b>Dielectric Strength</b>		Terminal to Terminal				Terminal to Case			
		160% VAC for 60 Seconds and 20°C applied between terminals				3KV at 60Hz for 60 Seconds applied between terminals and case			
<b>Load Life</b>		125% of rated VAC at 70°C							
		600 hours for class A (3000 hours of continuous service life)							
<b>Construction</b>		Metallized Polyester film							
<b>Electrodes</b>		Vacuum deposited metal layers							
<b>Coating</b>		Solvent resistant plastic case (UL 94V-0) with epoxy end fill (UL 94V-0)							
<b>Certification</b>		UL E311560							

# MER

Metallized Polypropylene  
MOTOR RUN/AC Film  
Capacitors in Round  
Tubes

## PHYSICAL DIMENSIONS

VAC ( $\mu\text{F}$ )	250	350	400	450	500	600
1	→	15x30	20x40	→	→	25x40
3	20x30	23x30	25x40	→	30x40	35x40
5	→	25x40	→	35x40	30x50	40x50
7	25x40	27x40	30x50	→	35x50	40x60
10	→	30x40	→	→	40x50	45x60
15	→	30x50	→	40x50	40x60	45x70
20	30x50	30x60	→	45x50	45x60	50x70
25	35x50	32x60	→	45x60	50x60	50x85
30	35x55	34x60	→	45x60	50x60	50x85
35	35x60	33x70	→	50x60	50x70	
40	40x60	36x70	→	→	50x70	
45	40x60	37x70	50x70	55x70		
50	40x65	38x70	50x70	55x85		
55	40x70	41x70	55x70			
60	→	41x70	55x70			
65	→	43x70	55x85			
70	45x70	42x100	55x85			
75	→	43x100	55x85			
80	→	45x100	55x85			
85	45x100	41x120	55x85			
90	45x100	41x130	55x85			
100	45x110	42x130	55x85			

Convert to inches divide by 25.4

DxL (mm)

**Additional Case styles and lead terminations available.  
Contact Illinois Capacitor, Inc. for details.**

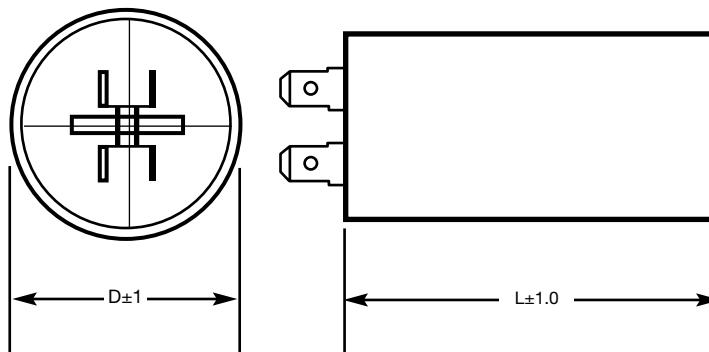

# MER

Metallized Polypropylene  
MOTOR RUN/AC Film  
Capacitors in Round  
Tubes

## STANDARD PART LISTING

Capacitance (µF)	VAC	IC <sup>®</sup> PART NUMBER	DxL (mm)
1	350	105MER350K##	15x30
1	400	105MER400K##	20x40
1	600	105MER600K##	25x40
3	250	305MER250K##	20x30
3	350	305MER350K##	23x30
3	400	305MER400K##	25x40
3	500	305MER500K##	30x40
3	600	305MER600K##	35x40
5	350	505MER350K##	25x40
5	450	505MER450K##	35x40
5	500	505MER500K##	30x50
5	600	505MER600K##	40x50
7	250	705MER250K##	25x40
7	350	705MER350K##	27x40
7	400	705MER400K##	30x50
7	500	705MER500K##	35x50
7	600	705MER600K##	40x60
10	350	106MER350K##	30x40
10	500	106MER500K##	40x50
10	600	106MER600K##	45x60
15	350	156MER350K##	30x50
15	450	156MER450K##	40x50
15	500	156MER500K##	40x60
15	600	156MER600K##	45x70
20	250	206MER250K##	30x50
20	350	206MER350K##	30x60
20	450	206MER450K##	45x50
20	500	206MER500K##	45x60
20	600	206MER600K##	50x70
25	250	256MER250K##	35x50
25	350	256MER350K##	32x60
25	450	256MER450K##	45x60
25	500	256MER500K##	50x60
25	600	256MER600K##	50x85
30	250	306MER250K##	35x55
30	350	306MER350K##	34x60
30	450	306MER450K##	45x60
30	500	306MER500K##	50x60
30	600	306MER600K##	50x85

Capacitance (µF)	VAC	IC <sup>®</sup> PART NUMBER	DxL (mm)
35	250	356MER250K##	35x60
35	350	356MER350K##	33x70
35	450	356MER450K##	50x60
35	500	356MER500K##	50x70
40	250	406MER250K##	40x60
40	350	406MER350K##	36x70
40	500	406MER500K##	50x70
45	250	456MER250K##	40x60
45	350	456MER350K##	37x70
45	400	456MER400K##	50x70
45	450	456MER450K##	55x70
50	250	506MER250K##	40x65
50	350	506MER350K##	38x70
50	400	506MER400K##	50x70
50	450	506MER450K##	55x85
55	250	556MER250K##	40x70
55	350	556MER350K##	41x70
55	400	556MER400K##	55x70
60	350	606MER350K##	41x70
60	400	606MER400K##	55x70
65	350	656MER350K##	43x70
65	400	656MER400K##	55x85
70	250	706MER250K##	45x70
70	350	706MER350K##	42x100
70	400	706MER400K##	55x85
75	350	756MER350K##	43x100
75	400	756MER400K##	55x85
80	350	806MER350K##	45x100
80	400	806MER400K##	55x85
85	250	856MER250K##	45x100
85	350	856MER350K##	41x120
85	400	856MER400K##	55x85
90	250	906MER250K##	45x100
90	350	906MER350K##	41x130
90	400	906MER400K##	55x85
100	250	107MER250K##	45x110
100	350	107MER350K##	42x130
100	400	107MER400K##	55x85

## to be assigned by Illinois Capacitor, Inc.

**Additional Case styles and lead terminations available.  
Contact Illinois Capacitor, Inc. for details.**

